

Christensen



MARATHON



M/Y Marathon Specifications:

Builder: **Christensen Shipyards Ltd.**

Year built: **2007**

Interior design: **Carol Williamson & Associates**

Naval architecture: **Christensen Shipyards Ltd.**

Flag: **Marshall Islands**

Terms: **MYBA**

Classification/certification: **ABS ✕ A1-AMS & MCA**

Number of Cabins: **6**

Total Guests (Sleeping): **12**

Cabin Configuration: **2 single, 4 double**

Bed Configuration: **not specified**

Captain's Name: **Christopher Lee / Bryan Pridgeon**

Port of Registry: **Bikini, Marshall Islands**

Deck Jacuzzi: **Yes**

Total Guests (Cruising): **12**

Total Crew: **10**

LOA: **47.85m (157')**

Beam: **8.99m (29' 6")**

Draft: **2.51m (8' 3")**

Gross Tons: **499**

Max. speed: **18 knots**

Cruising speed: **12 knots**

Range: **4300 nautical miles**

Hull material: **Composite**

Fuel consumption: **55 US gal/hr**

Engines: **MTU 12V 4000 Series**

Generators: **(2) 100kw Northern Lights**

(1) 65kw Northern Lights

Air conditioning: **Cruiseair 30 ton**

Stabilizers: **Naiaid 520**

Safety & Security: **4x 16 person life rafts, EPIRB, SOLAS life jackets, life rings, fire fighting equipment and smoke detectors, handheld GMDSS VHF, search and rescue transponder SART, gas leak detection, rescue tender, 7 surveillance cameras, electronically monitored external doors**

Tenders & Toys: **19' AB Tender w/ 150hp Honda 4 Stroke outboard
15' AB Tender w/ 75hp Honda 4 Stroke outboard
2x 3 man Sea Doo waverunners
2x 2 kayaks
1x 16' Laser Pico sailboat
Waterskis
Towable inflatables including 1 x 3 man Molicule
16 sets snorkeling equipment
SCUBA Diving - 6 full sets gear
Dive Compressor**

Exercise Equipment: **Stationary Bike
Elliptical Stepper
Boxing Bag and Gloves
Bowflex Selectex Dumbbells
2 Pilates mats + Ball
Weight Bench**

Main Foyer



Main Salon



Dining Room



Master Stateroom



Guest Stateroom



Sky Lounge



Guest Stateroom



Bridge Deck



Aft Main Deck



Sun Deck

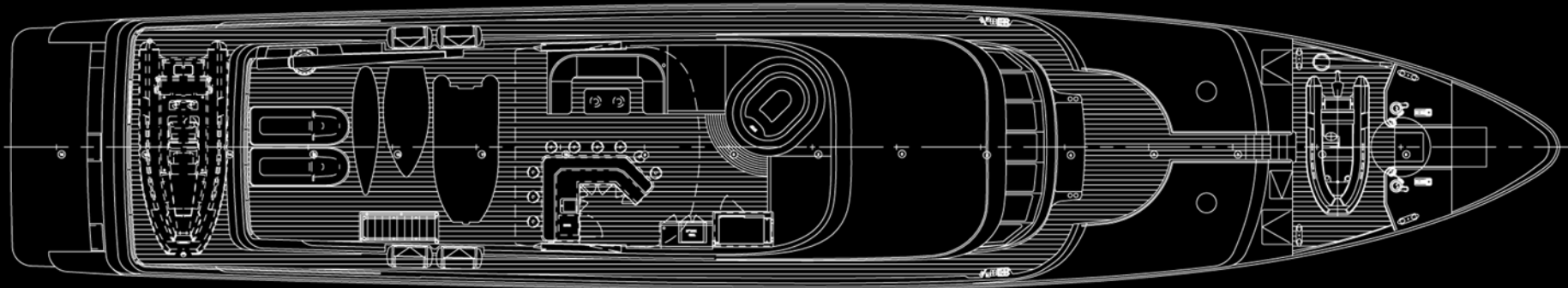

BOAT DECK PLAN

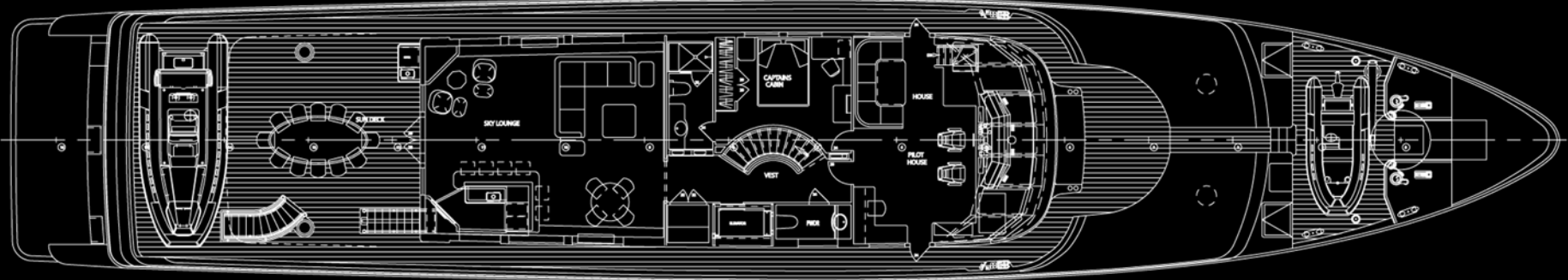

MAIN DECK PLAN

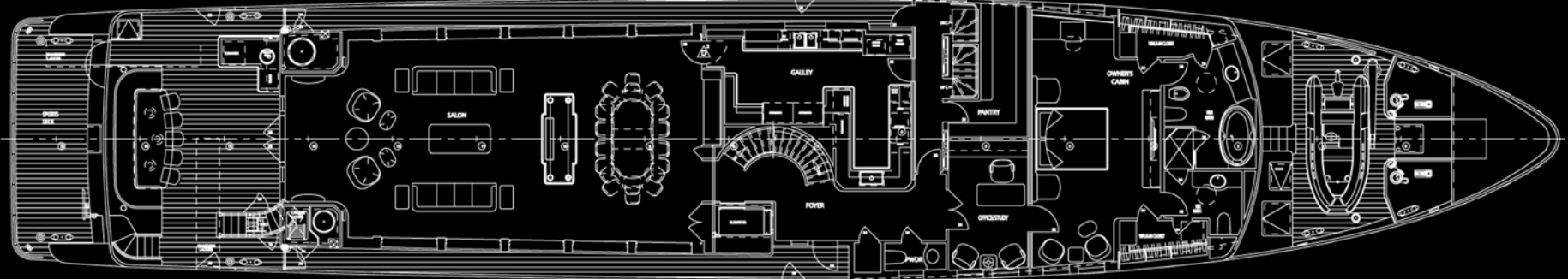

LOWER DECK PLAN

Special Features: Elevator to all decks
Alfresco Dining on the Sun Deck, Bridge Deck and Aft Main Deck
Spacious Interior Accommodations
SCUBA Diving for certified divers *VSAT

Staterooms have flat screen Satellite TV, Crestron Controllers and remote access to the central entertainment system for music and videos.

Master Suite on Main Deck: King, w/ en-suite his/hers bathroom with tub and separate shower. Comfortable sitting area. Walk-in closet from the bathroom or the stateroom. Private Owner's office.

VIP Below Deck: King w/ spacious bathroom with tub and shower.

2x Guest Below Deck: Kings, Equal size, both w/ en-suite bathrooms w/ showers.

2x Guest Below Deck: Both have one standard Twin, one Double and a Twin Pullman w/ en-suite bathrooms w/ showers.

Sun Deck

Jacuzzi forward w/ large cushioned sun pad on one side, Elevator service to all decks, BBQ grill, bar w/ stools and adjacent baquette for casual dining for 12. Spacious aft deck carries water sports equipment. Design of the super structure provides shade at the bar and dining area.

Bridge Deck

Aft of the bridge is the spacious sky lounge with bar, cocktail/game table and conversational area.

On the aft bridge deck there is a covered dining for 12 guests and room for lounge chairs on the open deck.

Main Deck

Forward of the bridge is exterior seating and a table for 8 guests.

The master suite described above is forward, followed by the foyer for the starboard entry to the yacht, the powder room and galley, and a stairway and elevator to all decks.

The dining area has a large table w/ seating for 12 guests. Providing semi privacy between the salon and the dining area is a center credenza with hidden wide screen T.V. When raised, the TV can swivel for viewing in either room. Large windows extend along the dining area and the salon providing natural light and an excellent view.

Main Salon is spacious with plush seating and conversational area and a full entertainment center

Main Deck Aft: Dining for 12. Wet bar. Stairway to the bridge deck and easy access to the swim platform.

Below Deck

Five Staterooms and bathrooms as described above. Entrance to the guest laundry opposite the elevator.

Audio Visual Equipment and Deck Facilities

Sat TV

Crestron Controllers (one touch panels) controls all audio/video equipment

Central entertainment center with DVD's and CD's

Docking station for IPOD

Communications

VSAT Internet - 24/7 unlimited data. Wireless throughout